

LTECH

Super Smart Switch (4-Gang)



Manual
www.ltech-led.com

Application Diagram

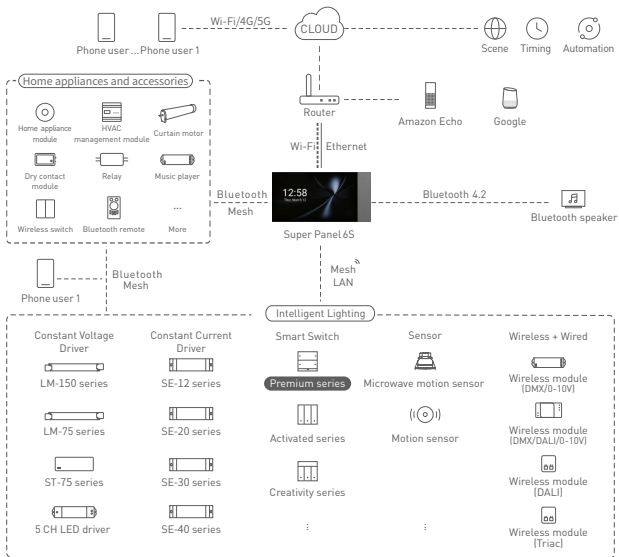

Product Features

- Use CNC aluminum alloy buttons. Available in four colors that can be blended seamlessly into any decorating style.
- 4-gang switch with the latest Bluetooth 5.0 SIG Mesh technology turns traditional lights into smart ones.
- Completely turn lights off and stop LED lights from glowing. It is energy-efficient and secure.
- Work with gateway devices to achieve automation for lighting control.
- Bluetooth 5.0 SIG Mesh with high networking capacity is reliable and stable.
- Support local scenes that can run without the Internet or a gateway. It is faster and more stable
- Designed with the 86 type junction box. No need to modify the existing wiring. Easily install the switch and be ready to use right out of the box.

Technical Specs

Model	S4M
Wireless Protocol Type	Bluetooth 5.0 SIG Mesh
Input Voltage	100-240V~, 50/60Hz
Single Load	LED≤200W ,  ≤400W (4 Channels)
Inrush current in loads	Max.65A@2ms
Working Temperature	-20°C~55°C
Working Humidity	≤80%RH
Colors	Grey/ Pink/ Silver/ Gold
Net Weight	160g
Dimensions(L×W×H)	86×86×36.5(mm)
Package Size(L×W×H)	102×102×60(mm)



Product Images

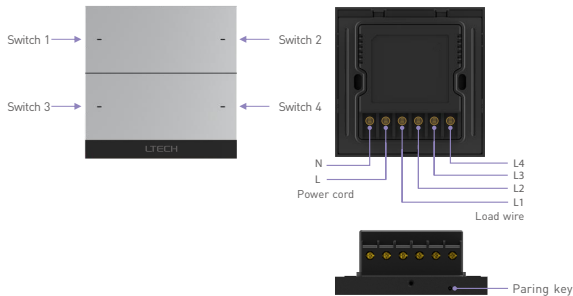

Product Size

Unit: mm

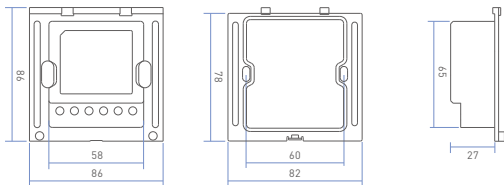

Installation Instructions

1. Turn off the circuit breaker and remove any concrete or corrosion that are inside the wall box. Trim the power cord wire in the wall box to 10cm in length approximately.



2. Pry the switch plate up with a flat head screwdriver.

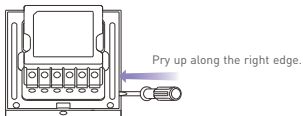

3. Attach the live line to L socket of the switch and the null line to N socket, and the load power cord wire to L1/L2/L3/L4 socket. Make sure the power cord wires are well connected to the switch terminals with no copper wire exposed. (The protection device for the electronic switch cannot be greater than 35A)

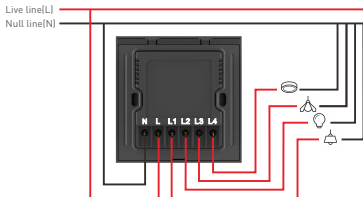

4. Insert the screws into the hole on two sides of the switch and secure the screws to fit the switch to the wall with a screwdriver.

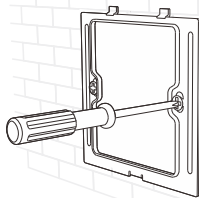

5. Slant the switch plate cover and put it in place, then secure the plate cover to the switch from the bottom with a KM2 screw.

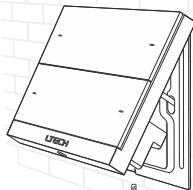

KM2 screw

Recommended Applications

1. Connect to traditional lamps and turn them into smart ones.

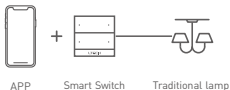

2. Wireless control.

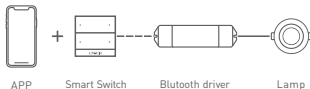

3. Support local scenes that can run without the Internet or a gateway.



4. Visual control + Scene linkage.

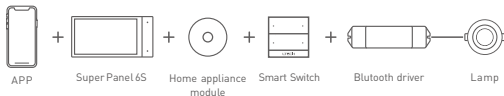

5. More applications of intelligent control are waiting for you to set up.

App Operating Instructions

1. Register an account

1.1 Scan the QR code below with you mobile phone and follow the prompts to complete the app installation.



Scan and download the App

1.2 Open the App and log in or register an account.

1.3 Create a home if you are a new user. Click "+" icon in the upper right corner to access "Add Device" list.

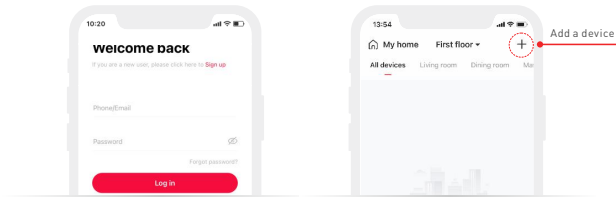

2. How to bind lights/light groups

Bind lights/light groups: Go to the device interface and long press the key you want to bind. Or go to the settings to click the key your want to bind. Then click "Bind object" and pick a light or a light group, and set up turning on/off and adjusting brightness by a short press and a long press. After clicking "Save", you are able to control Bluetooth lights or light groups with a Bluetooth switch panel.

Bind keys of the other switch panel: Go to the device interface and long press the key you want to bind. Click "Bind object" and pick a switch panel, then pick the key of the switch panel you want to bind. The key you pick allows turning on and off, turning on, turning off only. It is recommended to apply to those scenes that require controlling multiple traditional lights.

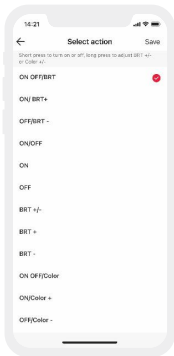
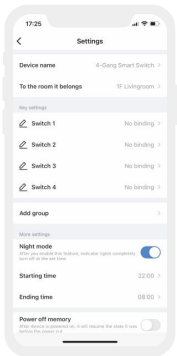
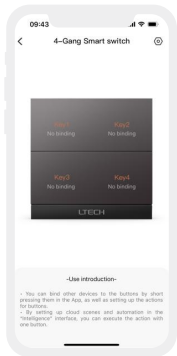

3. How to create a switch panel group

In "Add device" interface, click "Group" and pick the smart switch group you need. Create a smart switch group, then rename the group and set up the room it belongs to. Pick devices you want to add to the group, then the group will be created successfully. After creating the group, the data of sub devices of the group will be synchronized with the other switch panels of the group. So one device can be controlled by multiple panels.

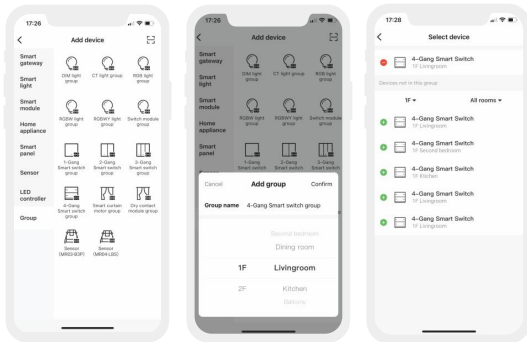

4. Advanced functions

- 4.1 Control the smart switch locally by linking it with a local scene
- 4.2 Work with a smart gateway (such as Super Panel 6S) to achieve a variety of cloud scenes and automatic control. For more details, please follow the on-screen instructions in the APP.

FAQs

1. What should I do if I fail to search the device via APP?

Please check below:

- 1.1 Please make sure the device is powered on normally and is in the activated state.
- 1.2 Please keep your mobile phone and device as close as possible. The recommended distance between them is no more than 15 meters.
- 1.3 Please make sure the device hasn't been added yet. If it has, please reset the device to factory defaults manually.

2. How to reset a switch to factory defaults?

Method 1: Insert an ejection pin into the pairing key at the bottom of the panel and long press it for 6s. When all the indicator lights flash slowly, it means that the device has been set to factory defaults.

Method 2: Please long press the last button for 15s and release it until all the indicator lights flash fast. Within 3s, short press the same button 3 times and the indicator light flashes slowly, which means the device has been reset to factory defaults.

Attentions

- Products shall be installed by qualified professionals.
- LTECH products are non-waterproof (special models excepted). Please avoid the sun and rain. When installed outdoors, please ensure it is mounted in a water proof enclosure.
- Good heat dissipation will extend the working life of products. Please ensure good ventilation.
- Please check if the working voltage used complies with the parameter requirements of products.
- The diameter of wire used must be able to load the light fixtures you connect and ensure the firm wiring.
- Before you power on products, please make sure all the wiring is correct in case of incorrect connection that causes damage to light fixtures.
- If a fault occurs, please do not attempt to fix products by yourself. If you have any question, please contact your suppliers.

* This manual is subject to changes without further notice. Product functions depend on the goods. Please feel free to contact our official distributors if you have any question.

Warranty Agreement

Warranty periods from the date of delivery : 2 years.

Free repair or replacement services for quality problems are provided within warranty periods.

Warranty exclusions below:

- Beyond warranty periods.
 - Any artificial damage caused by high voltage, overload, or improper operations.
 - Products with severe physical damage.
 - Damage caused by natural disasters and force majeure.
 - Warranty labels and barcodes have been damaged.
 - No any contract signed by LTECH.
1. Repair or replacement provided is the only remedy for customers. LTECH is not liable for any incidental or consequential damage unless it is within the law.
 2. LTECH has the right to amend or adjust the terms of this warranty, and release in written form shall prevail.