

Product Acknowledgement

Customer Name : _____

Product Name : Switch module

Product Model : RELAY-BLE01

Product Specifications : _____

Product NO. : _____

Confirmed by LTECH

Drafted by	Verified by	Approved by
Xu Shujun	Tan Lianle	Luo Shengdong

Confirmed by Customer

Checked by	Verified by	Approved by



RELAY-BLE01

Switch module

- Small size and light weight.
- Bluetooth 5.0 SIG Mesh with high networking capability is reliable and stable.
- Zero -crossing detection extends the life of a switch.
- Support online upgrade, cloud scenes and automation.
- Support direct control on iOS or Android devices through Bluetooth connection.
- Controlled by a remote, a wireless panel or a group via a LAN network without connecting to a gateway.
- Work with the Super Panel to achieve remote control.



Technical Specs

Model	RELAY-BLE01
Wireless Protocol Type	Bluetooth 5.0 SIG Mesh
Working Voltage	100-240Vac, 50/60Hz
Max. Load Power	≤400VA(Capacitive Load), ≤800W(Resistive Load)
Working Temperature	-20°C~55°C
Switch Channel	Single Channel
Protection	Zero -Crossing Detection
Dimensions	80×35×23mm(L×W×H)
Package Size	93×43×27mm(L×W×H)
Weight (G.W)	75g±10g

Product Size

Unit : mm

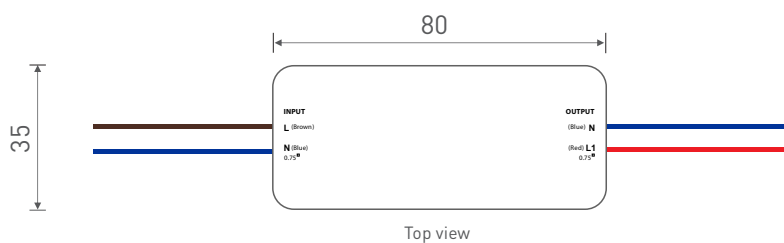

Wiring Diagram

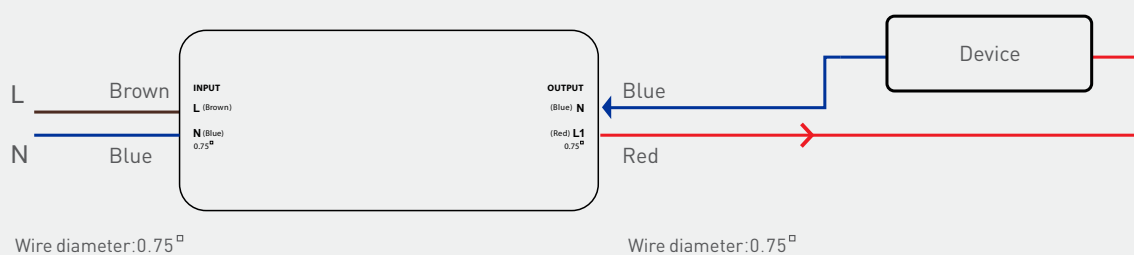

* Access the network to control through App and Bluetooth.

Application Diagram

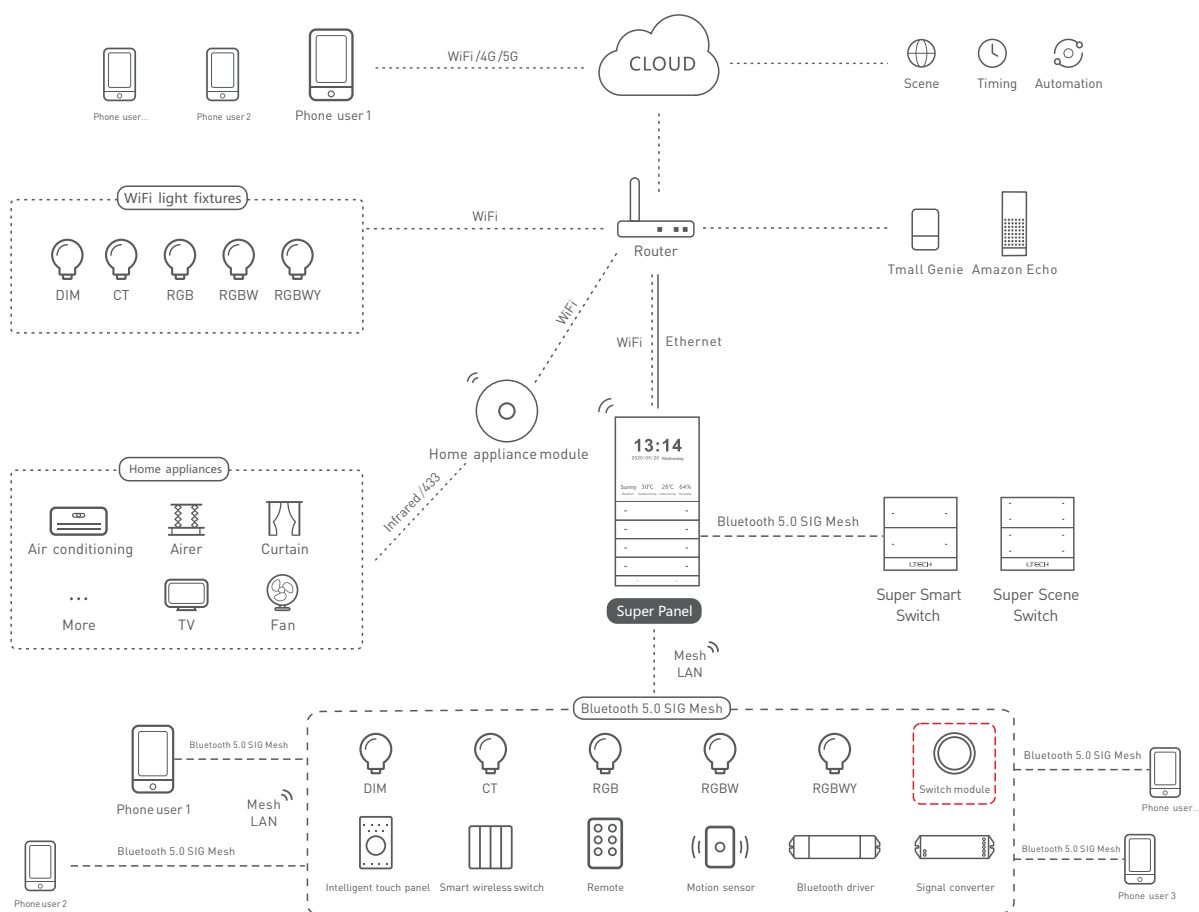

Recommended Applications

- 1、 Quickly turn the switch module on or off through Bluetooth control.

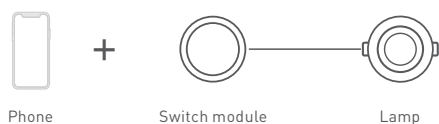

- 2、 Turn the switch module on or off both with the App and a remote after linking up the remote with the switch module via App.

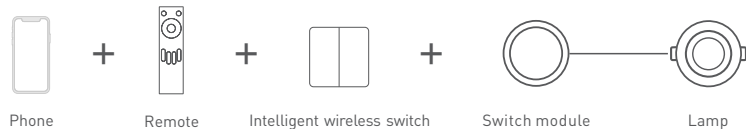

- 3、 Turn the switch module on or off both with the App and Super Panel after linking up the Super Panel with the switch module via App.
By connecting the Super Panel to the network, you can remotely turn the switch module on or off, achieve cloud scenes and automation by using the App.



- 4、More applications of intelligent control are waiting for you to set up.

Other Instructions

If the switch module works with a remote, gateway ,intelligent wireless switch or other items ,please refer to related manuals.

App Operating Instructions

1. Register an account

1.1 Scan the QR code below with you mobile phone and follow the prompts to complete the app installation.



Scan and download the App

1.2 Open the App and log in or register an account.

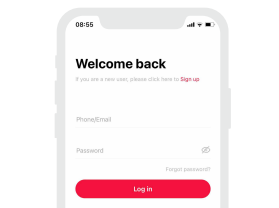

2. Add a switch module

Create a home if you are a new user. Click "+" icon in the upper right corner and access the "Add Device" list to pick "Switch Module". Then follow the prompts to power on the switch module first, and make sure the module is not connected to a network. Click "Bluetooth Search" to add the switch module according to the prompts.

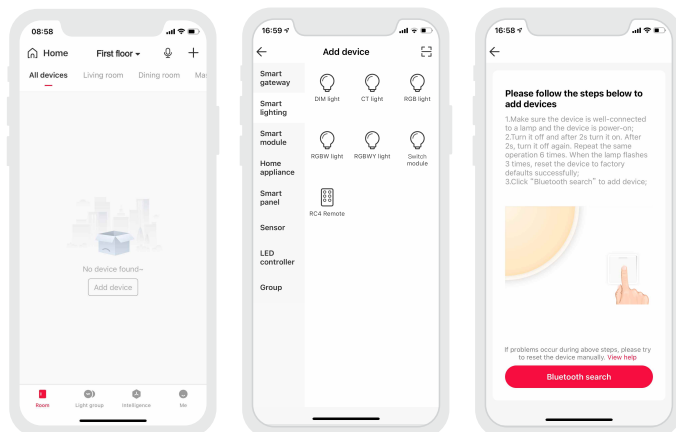

3. Bind the switch module

After adding the switch module, go to the interface of a smart remote and a wireless smart switch for binding the switch module. After you pick the switch module and bind it to the remote, you can turn the switch module on or off both with the smart remote and the smart switch, and meanwhile you can unbind it in this interface as well.

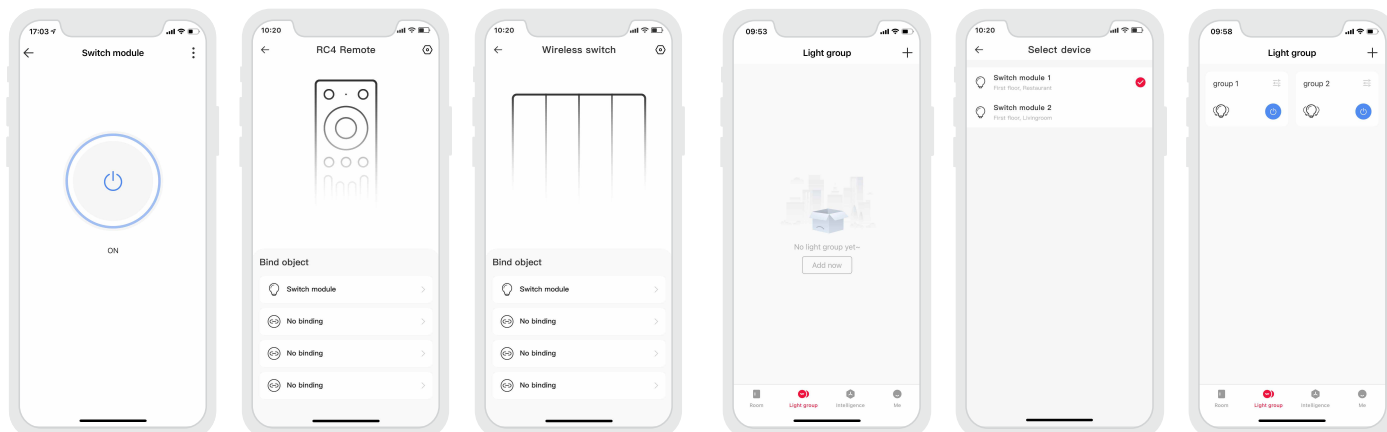

5. Advanced functions

The switch module can be linked up with gateway function devices (such as LTECH Super Panel) to achieve the advanced functions from cloud scenes to automation.

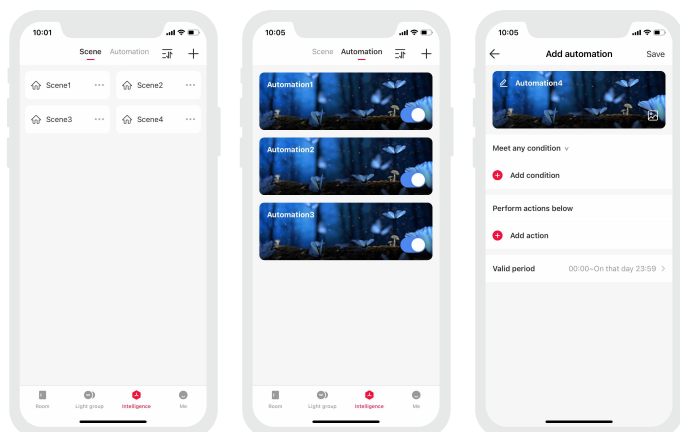

How to reset a switch module (reset it to factory defaults)

Make sure the switch module is connected to a lamp and keep the lamp on, then press the switch to continuously turn on and off the switch module 6 times, which means the switch module has been set to factory defaults.

Attentions

- Products shall be installed by qualified professionals.
- LTECH products are non-waterproof (special models excepted). Please avoid the sun and rain. When installed outdoors, please ensure it is mounted in a water proof enclosure.
- Good heat dissipation will extend the working life of products. Please ensure good ventilation.
- Please check if the working voltage used complies with the parameter requirements of products.
- The diameter of wire used must be able to load the light fixtures you connect and ensure the firm wiring.
- Before you power on products, please make sure all the wiring is correct in case of incorrect connection that causes damage to light fixtures.
- If a fault occurs, please do not attempt to fix products by yourself. If you have any question, please contact your suppliers.

* This manual is subject to changes without further notice. Product functions depend on the goods. Please feel free to contact our official distributors if you have any question.

Warranty Agreement

- Warranty periods from the date of delivery : 2 years.
- Free repair or replacement services for quality problems are provided within warranty periods.

Warranty exclusions below:

- Beyond warranty periods.
 - Any artificial damage caused by high voltage, overload, or improper operations.
 - Products with severe physical damage.
 - Damage caused by natural disasters and force majeure.
 - Warranty labels and barcodes have been damaged.
 - No any contract signed by LTECH.
1. Repair or replacement provided is the only remedy for customers. LTECH is not liable for any incidental or consequential damage unless it is within the law.
 2. LTECH has the right to amend or adjust the terms of this warranty, and release in written form shall prevail.

Update Log

Version	Updated Time	Update Content	Updated by
A0	2021.04.29	Original version	Xu Shujun